

Waikiki Beach

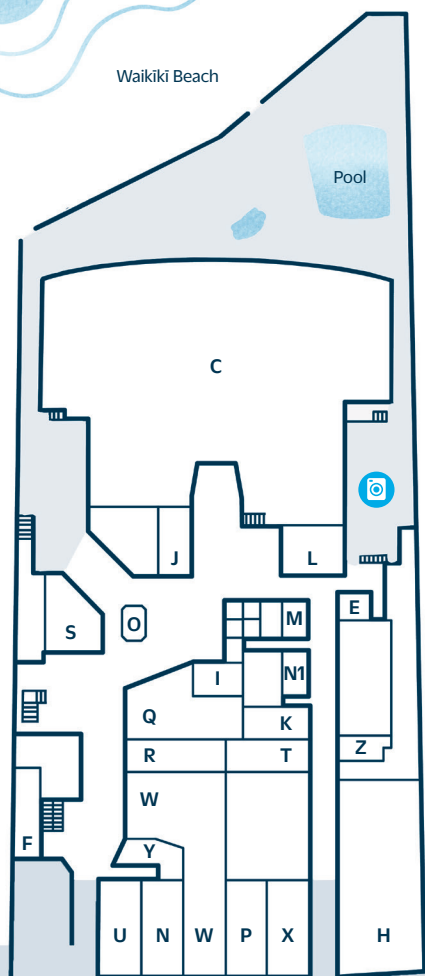

Kalākaua Avenue

View of Waikiki Beach

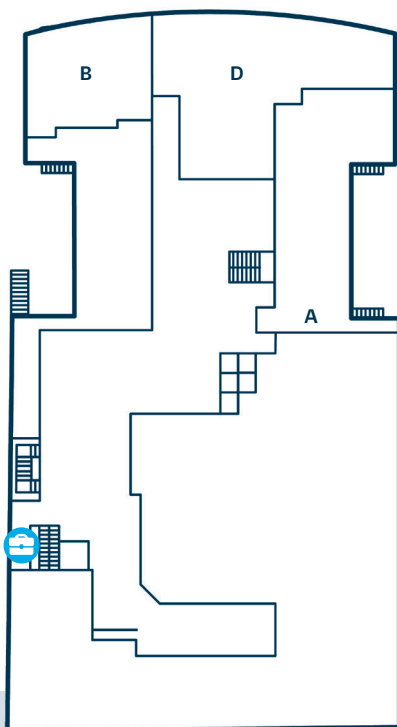

Kalākaua Avenue

PROPERTY MAP KEY

Ground Floor

Outrigger Activities **Daily: 8 am – 5 pm**

 Self-Service Laundry
Daily: 6:30 am – 10 pm

PROPERTY MAP KEY

Upper Floor

Penthouse

Fitness Center **Open 24 hours**

Infinity Fitness & Massage **Daily: 9 am – 6 pm,**
By appointment only

Shopping

A BLUE NOTE HAWAII & GIFT SHOP
Premier entertainment venue featuring live music & stand-up comedy. **Daily: 10 am – 9 pm**
(closing hour varies)

B VOYAGER 47 CLUB LOUNGE
Exclusive lounge with ocean views serving daily complimentary breakfast & happy hour. **Daily: 6:30 - 9:30 am & 4:30 - 6:30 pm**

C DUKE'S WAIKIKI
Beachfront dining & live music. Serving breakfast, lunch & dinner. **Daily: 7 - 12 am**

D Hula Grill
Authentic flavors of Hawaii sourced locally. Breakfast, lunch & dinner. **Daily: 7 am - 10 pm**

E Pai's Deli
Fresh sandwiches, salads & snacks made in a snap. **Mon-Sat: 9 am - 5 pm & Sun: 9 am - 4 pm**

F Sunrise Shack
Bullet coffee, pressed juices, smoothies & healthy eats. **Daily: 6 am - 7 pm**

H TORI RICHARD
Premier resort apparel for the family. **Daily: 9 am – 9 pm**

I FANTESEA JEWELRY
South Sea Tahitian black pearls & Hawaiian Heirloom jewelry. **Daily: 10 am – 9 pm**

J DUKE'S SURF SHOP
Pick up new styles for an epic day at the beach at Duke's Surf Shop! **Daily: 8 am – 10 pm**

K GALLERIA GIFTS
Hawaiian-themed t-shirts & variety of gifts and souvenirs. **Daily: 11 am – 9 pm**

L COOKIES CLOTHING HAWAII
Fun and flirty affordable clothing for women **Daily: 9am – 9:30 pm**

M ISLAND JEWELRY
Elegant handcrafted Hawaiian heirloom jewelry. **Daily: 11 am – 9 pm**

N HONOLULU COOKIE COMPANY
Premium shortbread cookies using only the finest and freshest ingredients. **Daily: 9 am – 9 pm**

N1 MAKING WAVES WAIKIKI
Authentic, handmade jewelry, woodcraft and gift items. **Daily: 10 am – 9 pm**

O PEARL FACTORY
Select an oyster to discover your very own pearl treasure. **Daily: 10 am – 8 pm**

P ROXY
Swimsuits, fitness clothes & accessories for women & children. **Daily: 8:30 am – 9 pm**

Q ABC STORES
Wide selection of gifts, beach needs, fine wines & groceries. **Daily: 6:30 am – 10:30 pm**

R BLUE GINGER
Original Hawaiian inspired resort wear designs for the entire family.. **Daily: 9 am – 9 pm**

S MALIBU SHIRTS
Variety of t-shirts, sweatshirts, custom board shorts and vintage clothing. **Daily: 9 am – 9 pm**

T MARIO'S HAIR SALON
A full-service salon for men and women. **Daily: 10 am – 6 pm. Appointment required**

U NA HOKU
Fine traditional and original Hawaiian jewelry collections that celebrate the island lifestyle. **Daily: 9:30 am – 9:30 pm**

W QUIKSILVER
The world's leader in surf and snowboard clothing, outerwear and accessories. **Daily: 8:30 am – 9 pm**

X SOHA LIVING
Unique costal chic and tropical luxury home and gift items **Daily: 10:00 am – 9 pm**